



FIRE DEPARTMENT PREVENTION BUREAU

MIKE VAN LOBEN SELS
Fire Chief
(209) 966-3622

3500 APRON AVE
ATWATER, CA 95301
OFFICE (209) 385-7347

MARK PIMENTEL
Division Chief
(209) 385-7450

LUMBER YARDS, PALLET YARDS AND SOLID BIOMASS FACILITIES

All pallet yards are required to have an Operational Permit on file with Merced County Fire Department and a Fire Clearance inspection prior to opening and to be conducted no less than annually to ensure fire, life and safety requirements are maintained. All requirements are subject to change.

Conditions of approval:

1. All gate access or building access shall have approved fire department locks or key boxes installed for emergency access. Lock boxes and padlocks can be found at www.knoxbox.com.
Procedure:
2. Shall have approved emergency access road with a minimum width of 20 feet and no overhangs under 13 foot 6 inches. Dead end roads or aisles shall not be permitted. A minimum of 2 emergency vehicle access points shall be readily available with approved locks to enter facility.
3. All storage piles shall be separated near property lines, buildings and adjacent piles by an access road at least 20-foot-wide or the height of the stack/pile whichever is greater.
4. Shall have approved fire protection features such as approved hydrant system, hose system or portable fire-extinguishers with a minimum rating of 4A-60B:C with a maximum spacing of 150 feet walking distance between extinguishers.
5. All industrial powered vehicles shall have approved fire extinguishers with a minimum rating of 1A-10B:C mounted on vehicle.
6. Piles shall not be larger than 20-foot-high, 20-foot-wide and 100-foot-long. (Subject to site inspection and Fire code official approval.)
7. Facility and buildings on site shall have address identification with approved lettering with a minimum brush stroke of 4 inches by ½ inch on contrasting background. Buildings shall be labeled Shop, Office, etc...
8. Shall have emergency pre-plan with all facility features identified. Pre-plans must contain facility contacts for emergency. Shall have a pre-plan map for identifying facility features such as, electrical disconnects, gas disconnects, hazardous materials area, storage piles, access roads and aisles, and buildings with location of hydrants, extinguishers or fire water storage areas.
9. Shall have a minimum 6-foot fence around facility for site security with approved lock.

SITE CHECK LIST:

PASS	N/C	N/A	CODE
			(CFC 505.1) Address identification. New and existing buildings shall have approved address numbers, building numbers or approved building identification placed in a position that is plainly legible and visible from the street or road fronting the property.
			(CFC 506.1) Key Box/Knox. Where access to or within a structure or an area is restricted because of secured openings or where immediate access is necessary for life-saving or fire-fighting purposes, the fire code official is authorized to require a key box to be installed in an approved location.
			(CFC 503.4) Obstruction of fire apparatus. Obstruction of fire apparatus access roads. Fire apparatus access roads shall not be obstructed in any manner, including the parking of vehicles.

			(CFC 503.2.1) Dimensions. Fire apparatus access roads shall have an unobstructed width of not less than 20 feet (6096 mm), exclusive of shoulders, except for approved security gates in accordance with Section 503.6, and an unobstructed vertical clearance of not less than 13 feet 6 inches (4115 mm).
			(CFC 503.2.3) Surface. Fire apparatus access roads shall be designed and maintained to support the imposed loads of fire apparatus and shall be surfaced so as to provide all-weather driving capabilities.
			(CFC 503.2.4) Turning radius. The required turning radius of a fire apparatus access road shall be determined by the fire code official.
			(CFC 503.2.5) Dead ends. Dead-end fire apparatus access roads in excess of 150 feet (45 720 mm) in length shall be provided with an approved area for turning around fire apparatus.
			(CFC 503.3) Marking. Where required by the fire code official, approved signs or other approved notices or markings that include the words NO PARKING-FIRE LANE shall be provided for fire apparatus access roads to identify such roads or prohibit the obstruction thereof. The means by which fire lanes are designated shall be maintained in a clean and legible condition at all times and be replaced or repaired when necessary to provide adequate visibility.
			(CFC 503.3) Fire lane marking. Where required by the fire code official, approved signs or other approved notices or markings that include the words NO PARKING-FIRE LANE shall be provided for fire apparatus access roads to identify such roads or prohibit the obstruction thereof.
			(CFC 310) Smoking. Post and enforce "NO SMOKING" signs.
			(CFC 507.5.4) Obstruction of hydrants. Unobstructed access to fire hydrants shall be maintained at all times. The fire department shall not be deterred or hindered from gaining immediate access to fire protection equipment or fire hydrants.
			(CFC 507.5.6) Hydrant protection. Where fire hydrants are subject to impact by a motor vehicle, guard posts or other approved means shall comply with Section 312.
			(CFC 304.3.3) Dumpsters. Dumpsters and containers with an individual capacity of 40.5 cubic feet or more shall not be stored in buildings or placed within 5 feet combustible walls, openings or combustible roof eave lines.
			(CFC 304.3.2) Waste containers. Containers with a capacity exceeding 5.33 cubic feet (40 gallons) shall be provided with lids. Containers and lids shall be constructed of noncombustible materials.
			(CFC 605.1) Electrical hazards. Identified electrical hazards shall be abated. Identified hazardous electrical conditions in permanent wiring shall be brought to the attention of the responsible code official. Electrical wiring, devices, appliances and other equipment that is modified or damaged and constitutes an electrical shock or fire hazard shall not be used. <i>*Including unprotected light bulbs on mounted light fixtures or light poles, and unprotected outlets</i>
			(Merced County Code 9.25.010) Weed abatement. The ordinance codified in this chapter is enacted to provide for the removal of weeds, rubbish, and other material that results in a fire hazard, and to establish a method of recovering cost for removal.
			(CFC 304.1.2) Weed abatement/vegetation. Weeds, grass, vines or other growth that is capable of being ignited and endangering property, shall be cut down and removed by the <i>owner</i> or occupant of the premises.
			(CFC 304.1.1) Waste material. Accumulations of wastepaper, wood, hay, straw, weeds, litter or combustible or flammable waste or rubbish of any type shall not be permitted to remain on a roof or in any court, yard, vacant lot, alley, parking lot, open space, or beneath a grandstand, bleacher, pier, wharf, manufactured home, recreational vehicle or other similar structure.
			(CFC 603.9) Gas meters. Above-ground gas meters, regulators and piping subject to damage shall be protected by a barrier - or otherwise protected in an approved manner.
			(CFC 316.6.2) Outdoor storage. Outdoor storage within the utility easement underneath high-voltage transmission lines shall be limited to noncombustible material. Storage of hazardous materials including, but not limited to, flammable and combustible liquids is prohibited.

		(T19 Sec. 567/568) Extinguishers required. One Class 2-A rated fire extinguisher shall be provided for each 3,000 square feet of light hazard fuel load or one Class 2-A extinguisher for each 1,500 square feet of ordinary hazard fuel load. Travel distance shall not exceed 75 feet. <i>*Minimum 2-A:10-B:C rating, mounted</i>
		(CFC 906.5) Extinguisher availability. Portable fire extinguishers shall be located in conspicuous locations where they will be readily accessible and immediately available for use. These locations shall be along normal paths of travel,
		(T19 Sec. 567.3) Extinguisher Mounting. Portable extinguishers shall be securely mounted on brackets or placed in cabinets.
		(CFC 906) Extinguishers. All extinguishers shall be inspected monthly, serviced annually and shall have a current service tag attached to them.
		(CFC 5704.3.4.4) Flammable and combustible liquids. Liquids for maintenance and operation of equipment. In all occupancies, quantities of flammable and combustible liquids in excess of 10 gallons (38 L) used for maintenance purposes and the operation of equipment shall be stored in liquid storage cabinets in accordance with Section 5704.3.2. Quantities not exceeding 10 gallons (38 L) are allowed to be stored outside of a cabinet when in approved containers located in private garages or other approved locations. If above 10 gallons: (CFC 5704.3.2.1.2) Labeling cabinet. Cabinets shall be provided with a conspicuous label in red letters on contrasting background which reads: FLAMMABLE-KEEP FIRE AWAY.
		(CFC 806.1.1) Trees. Natural cut trees shall not be displayed except in areas protected by an approved sprinkler system.
		(CFC 315.3.1) Ceiling clearance. Storage shall be maintained 2 feet or more below the ceiling in non-sprinklered areas of buildings or a minimum of 18 inches below sprinkler head deflectors in sprinklered areas of buildings.
		(CFC 703.1) Cracks or holes in walls. Restore fire-resistive construction. Maintain fire-resistive construction on walls and ceilings. Repair holes using fire-resistive construction. Replace missing ceiling panels which may provide means of rapid fire spread to above-ceiling area.
		(CFC 901.6.2) Fire Alarm. Inspect and test the fire alarm system as required, proved /maintain adequate records.
		(CFC 901.6) Fire Protection Systems. Fire protection systems, including sprinkler, hydrant, standpipe, smoke removal, shall be maintained in an operative condition at all times, and replaces or repaired when defective.
		(CFC 315.2.3) Mechanical Rooms. Remove combustibles and storage from mechanical and equipment room/s.
		Exits: (CFC 1028) Exits and exit paths shall not be obstructed in any manner. (CFC 1008.1) Exit doors shall be maintained in proper working condition. (CFC 1011.5.3) Exit signs shall be fully illuminated at all times.
		(CFC 304.1) Improve housekeeping: Maintain storage in neat and orderly manner, maintain aisles and clear exits, eliminate unnecessary combustible storage to minimize fire spread and facilitate fire control. No combustible storage permitted outside within 10 feet of property line. Store oily rags in metal container with tight-fitting lid.
		(CFC 605.5) Extension cords. Extension cords and flexible cords shall not be a substitute for permanent wiring extension cords and flexible cords shall not be affixed to structures, extended through walls, ceilings or floors, or under doors or floor coverings, nor shall such cords be subject to environmental damage or physical impact. Extension cords shall be used only with portable appliances.
		(CFC 605.9) Temporary wiring. Temporary wiring is allowed for a period not to exceed 90 days; such wiring is allowed for longer periods for construction, remodeling or repair of buildings or equipment.
		(NEC 370-15) Outlet covers: Each electrical outlet box shall have a cover, faceplate or fixture canopy. Open junction boxes and open wiring splices shall be prohibited. Appropriate covers shall be

			provided for all switches and electrical boxes.
			(CFC 605.3) Electrical Equipment. Working space and clearance. A working space of not less than 30 inches (762 mm) in width, 36 inches in depth and 78 inches in height shall be provided in front of electrical service equipment. Where the electrical service equipment is wider than 30 inches, the working space shall not be less than the width of the equipment. No storage of any materials shall be located within the designated working space.
			(CFC 605.3.1) Panel labeling. Doors into electrical control panel rooms shall be marked with a plainly visible and legible sign stating ELECTRICAL ROOM or similar approved wording. The disconnecting means for each service, feeder or branch circuit originating on a switchboard or panel-board shall be legibly and durably marked to indicate its purpose unless such purpose is clearly evident.
			3206.9.1 Width. Aisle width shall be in accordance with Sections 3206.9.1.1 and 3206.9.1.2. Exceptions: 1. Aisles crossing rack structures or storage piles, that are used only for employee access, shall be not less than 24 inches (610 mm) wide. 2. Aisles separating shelves classified as shelf storage shall be not less than 30 inches (762 mm) wide. 3206.9.1.1 Sprinklered buildings. Aisles in sprinklered buildings shall be not less than 44 inches (1118 mm) wide. Aisles shall be not less than 96 inches (2438 mm) wide in high-piled storage areas exceeding 2,500 square feet (232 m2) in area, that are accessible to the public and designated to contain high-hazard commodities. Exception: Aisles in high-piled storage areas exceeding 2,500 square feet (232 m2) in area, that are accessible to the public and designated to contain high-hazard commodities, are protected by a sprinkler system designed for multiple-row racks of high-hazard commodities shall be not less than 44 inches (1118 mm) wide. Aisles shall be not less than 96 inches (2438 mm) wide in areas accessible to the public where mechanical stocking methods are used.
			3206.9.3 Dead-end aisles. Dead-end aisles shall not exceed 20 feet (6096 mm) in length in Group M occupancies. Dead-end aisles shall not exceed 50 feet (15 240 mm) in length in all other occupancies. Exception: Dead-end aisles are not limited where the length of the dead-end aisle is less than 2.5 times the least width of the dead-end aisle.
			2809.2 Size of piles. Exterior storage shall be arranged to form stable piles with a maximum height of 20 feet (6096 mm) maximum width of 20 feet and no longer than 100 feet.
			Fire apparatus access roads. Fire apparatus access roads in accordance shall be 20 feet wide in and around all piles and no dead ends are permitted.
			2809.5 Fire protection. An approved hydrant and hose system or portable fire-extinguishing equipment suitable for the fire hazard involved shall be provided for open storage yards. Hydrant and hose systems shall be installed in accordance with NFPA 24. Portable fire extinguishers complying with Section 906 shall be located so that the distance of travel from the nearest unit does not exceed 75 feet (22860 mm).
			906.1 Portable Fire Extinguishers. All industrial powered vehicles shall have a approved fire extinguisher with a minimum rating of 1A-10BC. (Forklifts)

Example Emergency Pre-Plan map: All plot plans shall be drawn to scale

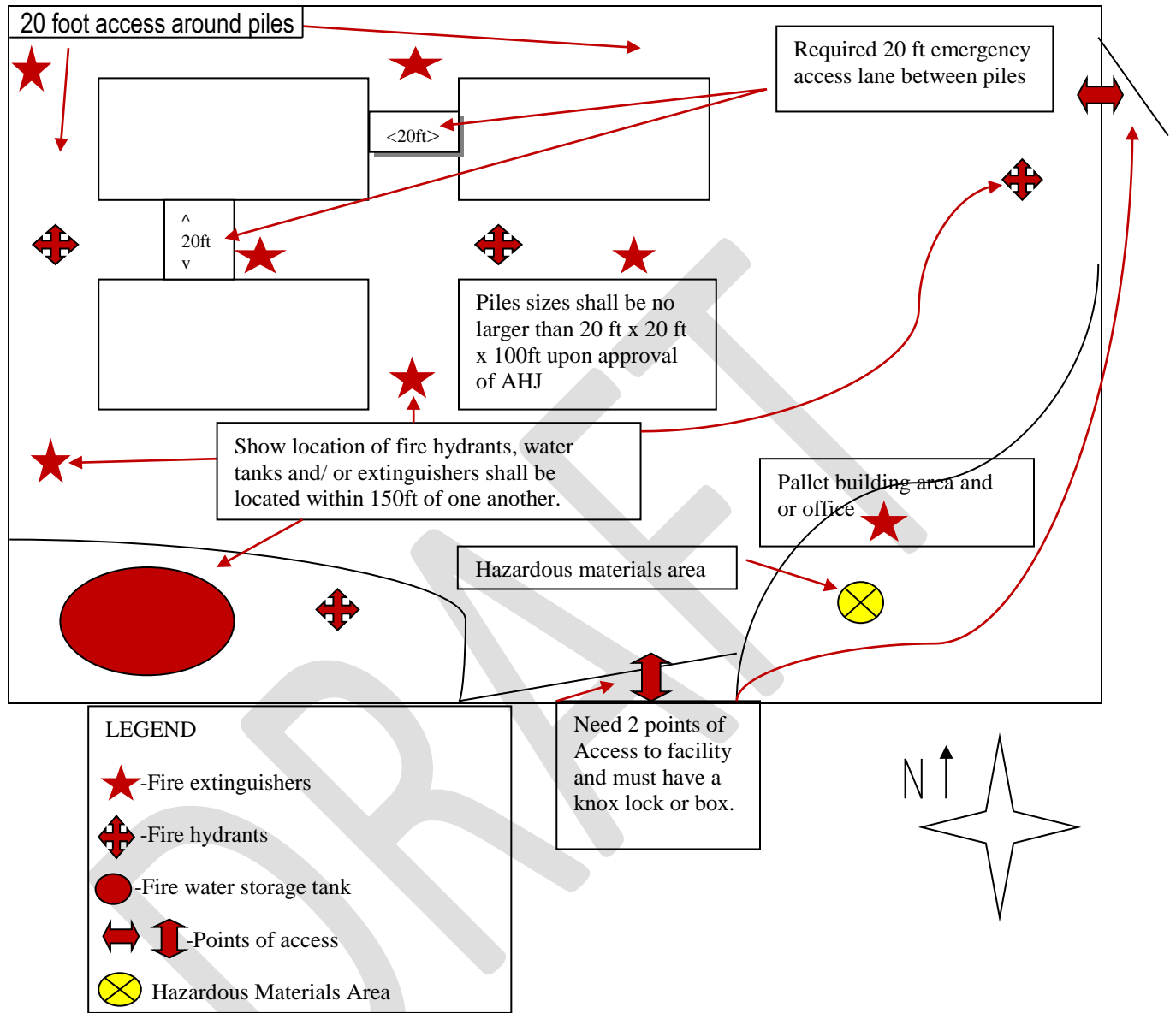

Emergency Pre-Plan Map/ Site Map:

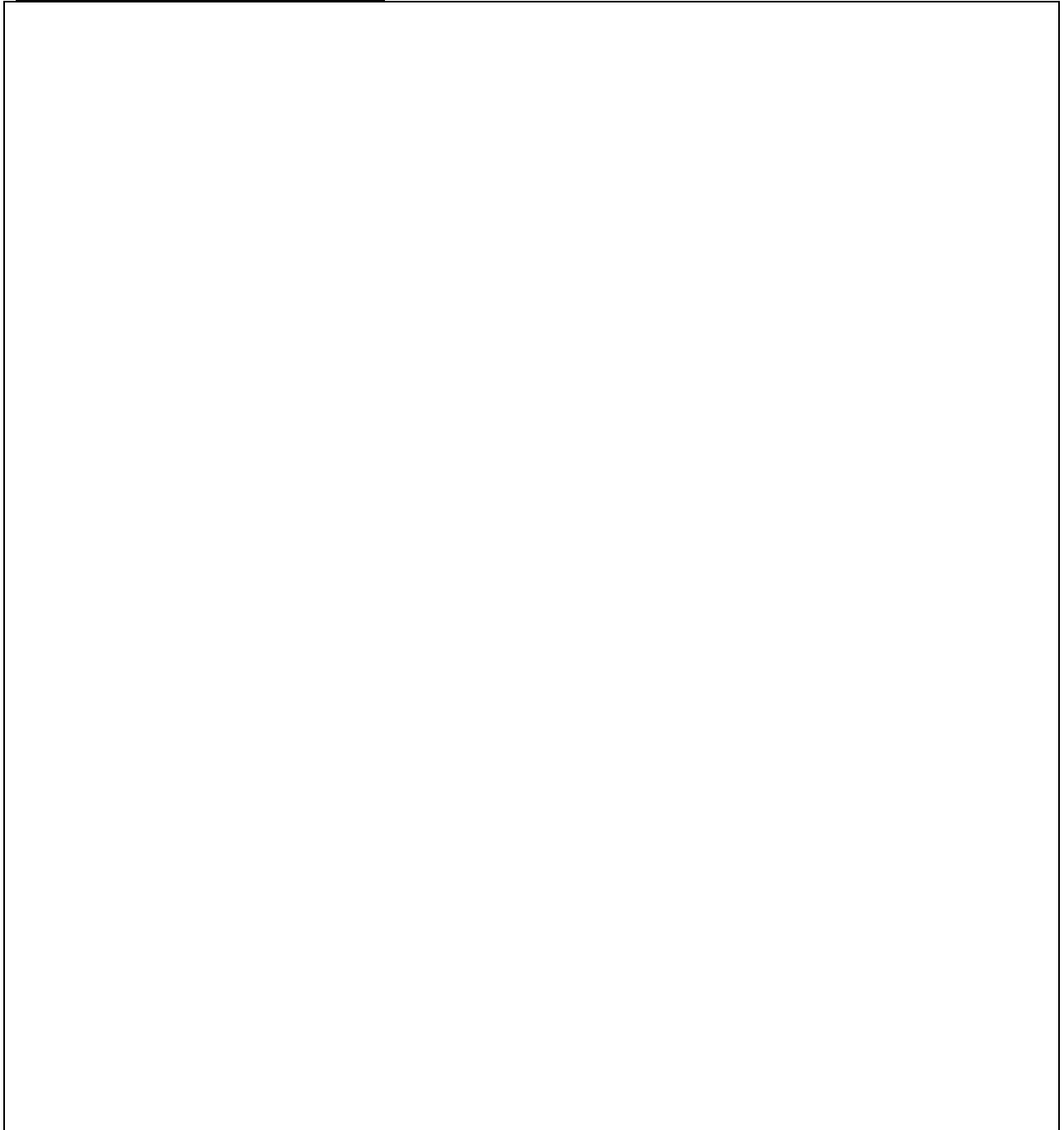

LEGEND

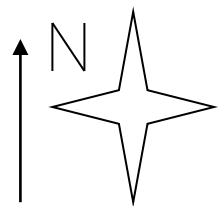
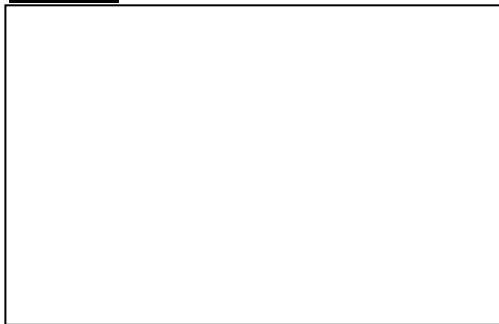



FIRE DEPARTMENT PREVENTION BUREAU

MIKE VAN LOBEN SELS
Fire Chief
(209) 966-3622

3500 APRON AVE
ATWATER, CA 95301
OFFICE (209) 385-7347

MARK PIMENTEL
Division Chief
(209) 385-7450

Operational Fire Permit Application

Application Date: _____

Describe Type of Business and/or
Services: _____

Business Name: _____

Business Owner: _____

Business License # _____

Expiration Date: _____

Business Address: _____

Mailing Address: _____

Event Address: _____

Event Date: _____ Event Time: _____

Business Phone: _____

E-Mail Address: _____

Contact Name: _____

Contact Phone: _____

Is this a new business? Yes No Date business opened at this location: _____

Did business relocate from another location? Yes No

If yes, provide address of former
location: _____

Operational Permits are **not transferable**. Operational Permits are to be renewed annually. If you stop conducting business at this location, you must notify the Merced County Fire Department, Fire Prevention Division. You must notify us also of any changes in business ownership, activity, location or name. By signing below I hereby certify that I have read and understand the terms above, and that under penalty of perjury the information provided on this application is true and correct. I also acknowledge that the Merced County Fire Department has adopted the Fire Code, and the amendments thereof and use of the permit(s) being applied for will conform to accepted standards.

Signature _____ Date _____